

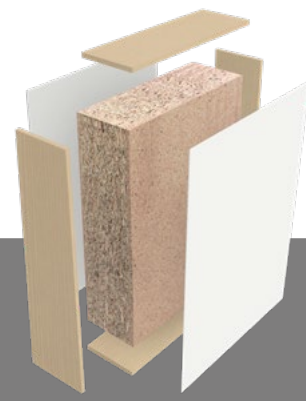

HALSPAN®





Optima FD60 54mm Fire Rated Interior Grade Door Blanks

Optima internal fire door blanks feature Halspan's unique 3-layer particle board. Specifically designed for the purpose, using a combination of chemical and engineering development, these blanks produce doors of altogether excellent quality, strength and overall performance.



Fire Rating FD60

Tested in Accordance with:	BS 476: Part 22: 1987, BS EN 1634-1:2000/2008 & BS EN 1363-1:1999		 
Maximum Approved Sizes* <small>(Please check standard supplied sizes shown overleaf) * Maximum approved sizes based on timber door frames. Refer to test data for full details.</small>	Single Doors	2441 x 1384mm	
		3050 x 825mm	
	Double Doors	2300 x 1142mm	
		2850 x 825mm	
Approved Frames	Timber, Hardwood, MDF		
Approved Glazing Size	0.82m ²		
Panel Effect	No		
Feature Grooves	Yes		



Acoustics

Tested in Accordance with:	BS EN ISO 10140-2:2010		
Acoustic Performance	Single Doors	Unglazed 34dB/Rw	
		Glazed 35dB/Rw	
	Double Doors	Unglazed 33dB/Rw	
		Glazed 35dB/Rw	



Environmental

U-value (Wm2K)	Heat loss per m ² 1.8 (doorset)	 Look for FSC certified products
Formaldehyde Release Rating	BS EN 13986 (2004) – Class E1	



Operational & Durability

Tested in Accordance with:	DD 171, EN 1191, EN 1192, EN 947, EN 949 & EN 950
Enhanced security performance requirements of door set	Tested to comply with PAS 24



General Properties

Weight	33.5kg/m ²
Density (±10%)	620 kg/m ³
Moisture Content	Ex factory 6-10%



Design Criteria

Stock Board Sizes	2135 x 915 mm 2440 x 915 mm 2440 x 1220 mm 2800 x 915 mm 2800 x 1830 mm 3050 x 1050 mm	Lipping Glue Lines	PVA PVAC U/F P/F PU
		Lipping Section Details	6 - 18 mm thick
		Rebated Lippings (double doors etc)	20 - 30mm thick
		Standard Intumescent	Palusol Graphite

Doorset Configurations

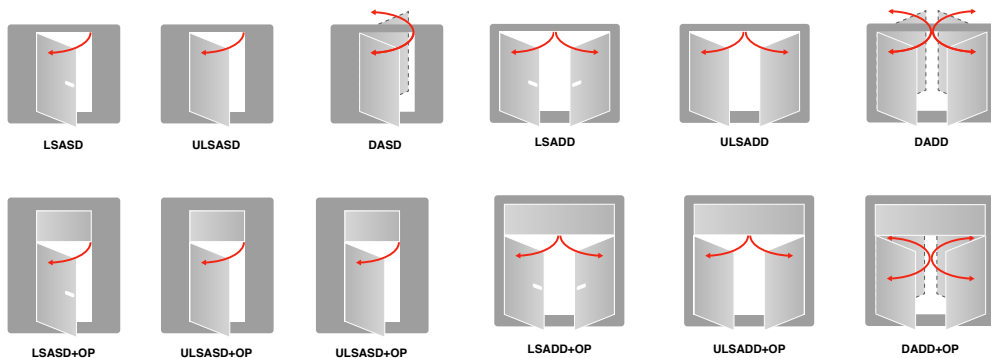

Design Options

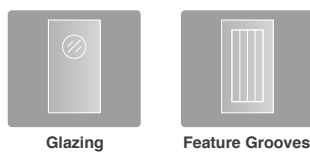

Seals & Hardware

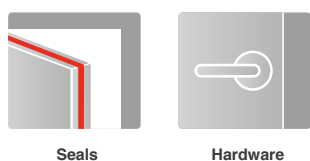

Refer to relevant product third party scope data and literature for further information.
 For technical guidance please contact the technical support team - technical@halspan.com